

## CCTV Camera

### Dome AHD Camera Quick Setup Guide



**Notes:** Before providing power for the camera, please read this User Guide in detail!

Do not attempt to disassemble the camera. If the camera can not work, please contact local franchiser or our company.

Franchiser:

For any technical assistance contact  
1860 233 3999

**BRIEF OF PRODUCT**

- \* **Sensor**  
1/4" CMOS Sensor.
- \* **Auto Gain Control (AGC)**  
Built-in auto gain control (AGC) circuit. The color camera can get high definition picture in low Lux condition.
- \* **Scanning Mode**  
NTSC or PAL mode.
- \* **Water Resistance**  
IP65.

**CONNECTING**

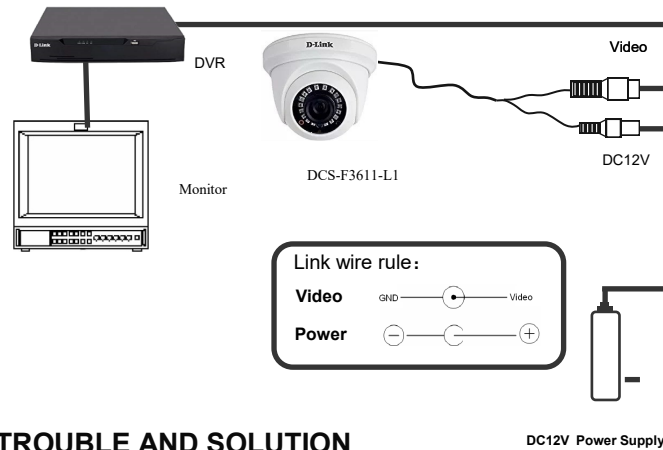

**TROUBLE AND SOLUTION**

- 1. No Picture after providing power**
  - . May be the power supply voltage abnormality, please check the power supply voltage.
  - . Please check all the connecting cable and monitors whether be connected correctly or not.
- 2. The picture level direction have flowing interference ripples**
  - . May be caused by the power supply AC ripples, it need filter the wave of the power supply.
  - . Check the monitor and peripheral equipment's used.
- 3. The picture background color changes continuously**
  - . The fluorescent lamp's electromagnetic field cause color roll. This is proper phenomenon of the cameras.
  - . Reduce the fluorescent lamp numbers or increase the distance between the camera and the fluorescent lamps can improve it.
  - . Use power supply external sync. camera can solve it.
- 4. The picture smear too mass**
  - . The power supply's voltage unstable.
  - . Connecting cables not connect correctly or have high impedance.



**Notes:**

- The power supply must through safe attestation. Its output voltage, current, voltage polarity and operating temperature must match the camera's requirement.
- When using the camera in the thunderbolt condition, please note to mount Anti-thunder device or put off the power supply plug and cable.
- In order to capture high quality pictures, the power supply's cable and video output cable should not be too long.

**INTRODUCTION**

Congratulations on your purchase of this product. This User Guide suits DCS-F3611-L1 product. We adopt the latest CMOS technical of sensor and driver. The most attractive characteristics are small and easy hidden, suits open area. In addition, it owns the characters of high definition and stability. Fixing and using this model are convenient too. It is very good for you to apply to your CCTV system. Please read this instruction manual carefully to ensure proper use of the product.



The symbol is intended to alert the user to the presence of important operating and maintenance (servicing) Instructions in the literature accompanying the appliance.



The symbol is intended to alert the user to the presence of uninsulated 'dangerous voltage' within the product's enclosure that may be of sufficient Magnitude to constitute a risk of electric shock to persons.

	<b>CAUTION:</b> <b>RISK OF ELECTRIC. DO NOT OPEN</b>	
<b>SHOCK</b> <b>CAUTION: TO REDUCE THE RISK OF ELECTRIC</b> <b>DO NOT REMOVE COVER OR BACK NO USER</b> <b>SERVICEABLE PARTS INSIDE. REFER SERVICING</b>		

**CAUTION: TO PREVENT ELECTRIC SHOCKS AND RISK OF FIRE HAZARDS, DO NOT USE OTHER THAN SPECIFIED POWER SOURCE.**



**Note:**

- Please note the camera's operating temperature and its using environment requirement. Avoid using the camera at too high or too low temperatures. The operating temperature is -30~+60℃. (Recommendatory operating temperature is -10~+50℃.)
- Never make the camera face the sun or bright object. Otherwise, it will damage the CMOS.
- Do not mount the camera near by the radiator or heater.